

Cove Oval

Community Consultation Findings
November 2025

Introduction

This report summarises community consultation for a pre-design plan for a playground upgrade at Cove Oval, Hallett Cove.

An Open Space Plan was endorsed by Council in 2024 to provide upgrades to open spaces across Council. As part of this plan a playground upgrade was recommended, to include the following elements:

- New Neighbourhood Playground
- Landscaping
- Seating and Shade

Consultation Program

Engagement occurred to ask community members about how they used the site and what they would like in a playground upgrade. The consultation survey was open for 3 weeks from 7 October to 28 October 2025.

The survey was made available online at makingmarion.com.au/cove-sports-playground-upgrade

Residents and Clubs were informed about the survey in the following ways:

- **Email** – Information was sent to all clubs and organisations who use the site
- **Onsite sign** – Five onsite signs were installed at the reserve and inside the clubrooms promoting the Making Marion link and consultation deadline.
- **Social media** - 2 posts promoting the survey.

Consultation Overview

Residents, clubs and organisations were invited to provide feedback for pre-design planning which asked about the types of play equipment preferred and to identify the preferred location for a playground. An online survey provided feedback from the community.

In total, during this consultation period Council received 104 survey responses.

A full summary of all responses to each survey question and relevant customer event feedback is provided within this report. Responses have been listed as worded by the respondent. For privacy reasons, respondents' details will not be included in a public report.

Consultation Findings

Overall, an upgrade for the playground at Cove Oval received positive comments and constructive feedback.

In summary:

- 104 responses to the survey were received.

Consultation results tell us:

- Visitors generally use the site weekly
- The majority (72%) of survey respondents use the complex for sporting club activities
- Access to the site is generally via car
- The preferred location for the playground is Location 2 (47%)
- The preferred JUNIOR play experiences are
 - Swinging
 - Sliding
 - Jumping
- The preferred ADVENTURE play experiences are
 - Parkour / Ninja Warrior
 - Monkey Bars
 - Climbing Structures
 - Gyro Swing
- The preferred facilities are
 - Shelter
 - Picnic tables
 - Drink fountain
 - Group Seating

Summary of feedback received

The table below identifies some of the feedback and items raised regarding the playground and open space upgrade and how this will be considered when finalising the concept design.

Community Feedback	Design Response
Preferred playground location is Location 2	The final location of the playground will be determined in part by the community preference as well as other potential precinct upgrades, Council requirements and site and budget constraints.
The preferred JUNIOR play options are: <ul style="list-style-type: none"> • Swinging • Sliding • Jumping 	We will endeavor to include these elements in the playground design subject to budget.
The preferred ADVENTURE play experiences are: <ul style="list-style-type: none"> • Parkour / Ninja Warrior • Monkey Bars • Climbing Structures • Gyro Swing 	We will endeavor to include these elements in the playground design subject to budget.
The preferred facilities are: <ul style="list-style-type: none"> • Shelter • Picnic tables • Drink fountain • Group Seating 	A shade sail and additional seating will be included within the reserve upgrade. Opportunities for shelter and picnic settings will be considered in coordination with any future potential precinct upgrades.
No public toilets / female changerooms need updating	A public toilet is not part of playground works and will be considered as part of potential clubroom upgrade works.
Needs a bike repair station	A bike repair station is not being considered in this project.
Car Park Improvements, including lighting	Car park improvements, including lighting, are not being considered in the playground upgrade but will be considered as part of potential clubroom upgrade works.
Access to amenities from oval / pathways	We will consider access in the design and work with a potential clubroom upgrade to improve access.
Poor Football amenities / sloping oval / old club rooms / poor scoreboard position	Upgrade of the football amenities is not part of playground works and will be considered as part of potential clubroom upgrade works.
Lack of fencing to separate dogs from activities	There are no plans to fully fence the oval or playground. Fencing may be designed at strategic locations to enhance play and provide safety subject to budget considerations
Trees / tree roots	Swamp Oaks will be removed which will open the site and reduce tripping hazards and access pathways will be designed. The amount of tree removal is subject to budget.

Maintenance of area	This item has been referred to the operations team.
Relocate BBQ from veranda	Club consideration – can be referred to potential building upgrade.
Increased Lighting	Not part of playground works
Power accessible outside of club rooms	Power outlets are not part of playground works and will be considered as part of the potential clubroom upgrade.
Playground construction to work with club upgrade	The design and construction of the playground will continue to work with the potential club room upgrade.
Drink fountain with dog bowl	Will be considered in the design
Increased shade / shelter	A shade sail will be included in the new playground. Additional shelter will be considered in coordination with other potential precinct upgrades.
Planted garden beds	New native, low-maintenance garden beds will be established around the playground.
Equipment for different ages / Fitness equipment	Equipment for different age groups will be included within the new playground. Ninja warrior/ parkour fitness trails will be included within the new playground.
Encourage recycling	Items that encourage cycling may be included in the potential club upgrade and worked into the playground design where possible.

SURVEY RESULTS

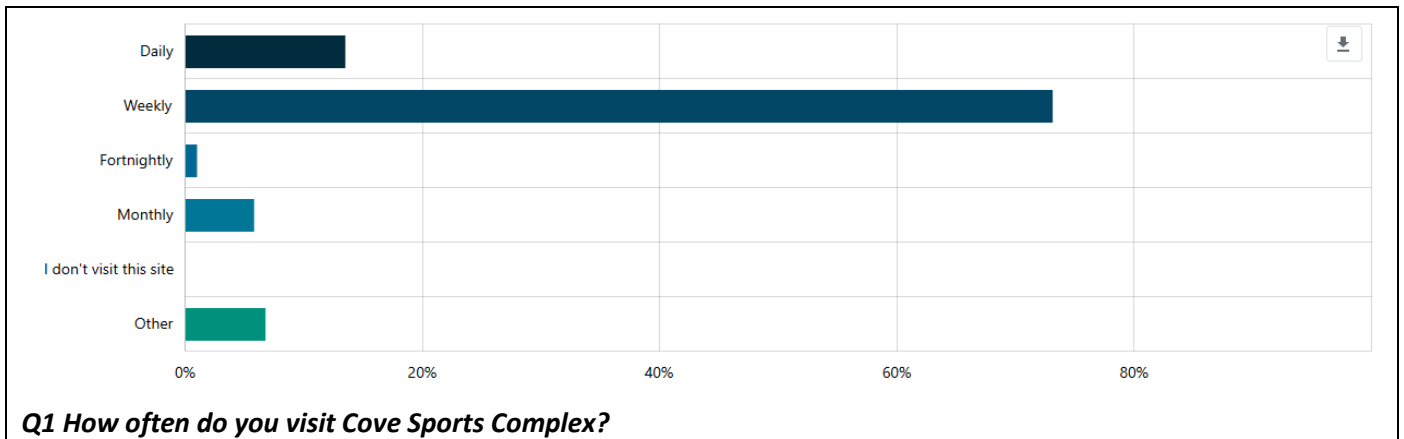

Other - Summer sports season, Friday nights, Saturdays all day, Sunday mornings, 3-4 times a week, twice a week

Summary of results: Respondents use the Oval regularly.

Q2 How do you currently use the Cove Sports Complex (can choose more than one)?

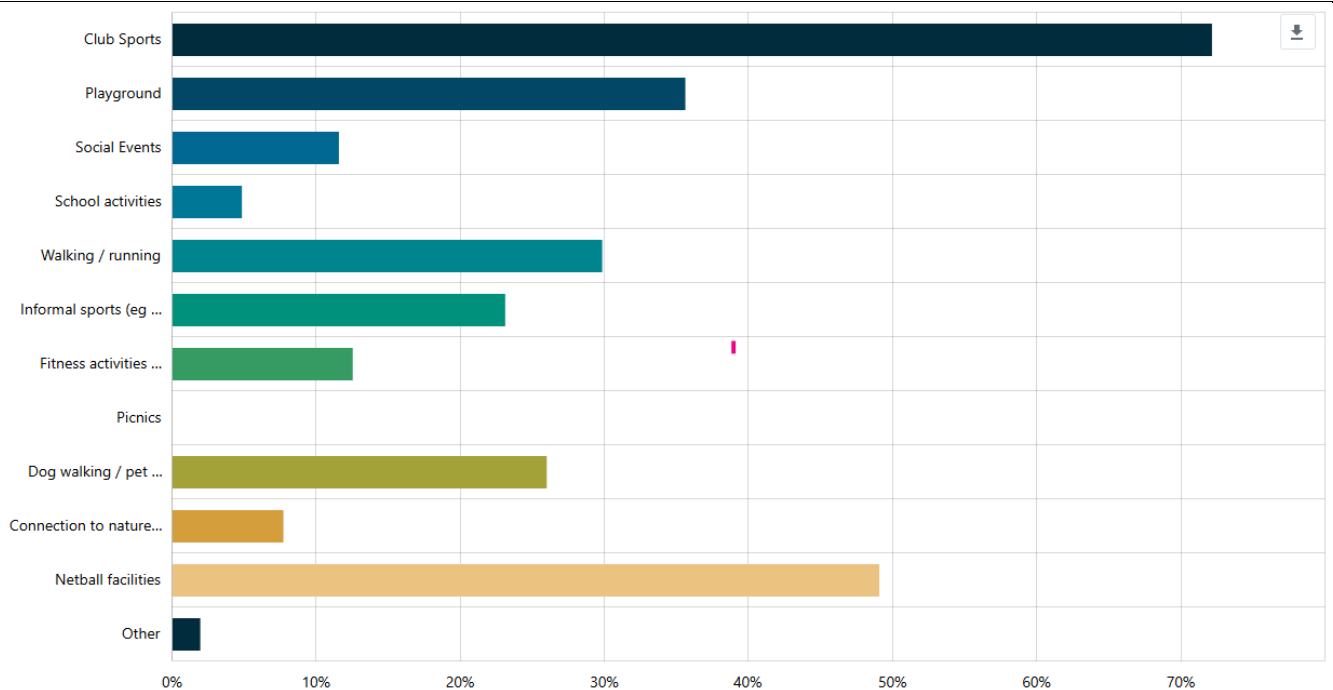

Other – Mountain bike riding, school

Summary of results:

72% of respondents use Cove Sports Complex as part of a sports club.

Q3. What do you like / don't like about the site?

<p>No access to public toilets. Not enough dog bags.. not enough respectful dog owners No facilities for biking ie bike repair stand / tools</p>
<p>Open area and easy access</p>
<p>The pathway around the new oval is fantastic.</p>
<p>Lack of lighting in the carpark, female public toilets desperately need upgrading - often blocked - no change other than paint since it was built,</p>
<p>The playground is old and definitely needs an upgrade.</p>
<p>The playground is not fenced so it's difficult to attend a sporting event to watch while my toddler wants to play on the playground</p>
<p>I think the play ground is a bit close to the football oval especially when senior games are being played and also the lighting near the play ground and also the car park needs major improvements</p>
<p>I feel there could be more of a path/track leading up from the carpark (behind the goals but towards the playground) to the oval. There are stairs right near the club room but I think a designated path to the oval would be a great idea. There are many people who walk through the trees there and with all of the random tree roots, it could be a tripping hazard. Would also be an easier way for people who have issues with walking on uneven grounds to get up there. Yes the building has a lift but if you go there when it's not open, then you have to either use stairs or walk through the bushes/trees. The female toilets could also use a good upgrade!</p>
<p>The slope has always been a factor in sports but thats a bit difficult to improve. The scoreboard position is not great at all and needs an update itself. The playground surface breaks up at the bottom of the slides. It's a good height for the younger kids, some of the playgrounds are too high.</p>
<p>for football games on rainy days you can't sit around the oval in your car, there's not much shelter either so people don't come to support the local games</p>
<p>Nice ovals but facilities are dated and not big enough for a growing club. Playground is old and small and no fencing means dogs can run around the kids when off leads.</p>
<p>We don't like the poor (terrible) acoustics in the oval bar</p>
<p>The ageing clubrooms. Council have invested millions in brand new Soccer & Netball facilities, but have left the clubrooms largely untouched over 40 years (not to mention all of the other sporting clubs in the council zone). Footy & Cricket Club members pay council fees too.</p>
<p>Lack of quality facilities (toilets, playground, seating areas outside, no disability toilets or disability access to watch games. Parking can also be a challenge and unsafe.</p>
<p>Would like more of an easier access for top oval with wheelchairs or mobility scooters.</p>
<p>Like New oval is excellent Top oval is in good condition</p> <p>Dont like or suggested improvements Better pedestrian access from carpark More parking Better lighting in car park Toilet facilities require updating currently only 2 x cubicles More seating around the ovals</p>

Club Rooms and toilets need a major upgrade in the upgrade would be great to have toilets open not just when the sporting clubs are open so this playground could be used other times of the year.
Like the location.
Nice ovals
Enclosed by trees, however in summer lots of loose tree debris makes good spot for snakes and unsafe for kids. Nothing for kids not playing sport to do.
The playground was very small and only aimed at younger children. Would be great to have some things for primary school aged students.
Clubrooms need upgrading- all other clubrooms in the SFL have been upgraded.
The toilet facilities at the sports club are terrible bordering on 3rd world conditions there needs to be a drastic improvement.
Not enough car park lighting, messy trees make the site look untidy
Not enough lighting in the carpark. It would be great to have a clear path leading from the carpark to the oval. Currently at night it is dark and very slippery when walking down with the dirt & debris from the trees. Hazard when leaving the oval with no lighting or clear path.
Needs more dog poo bags.
Playground floor ripping apart.
Needs more seating around oval
New oval and parking is fantastic
Lovely open space for us and our kids whom are both involved in sports
na
Needs more sitting areas around
I like the big ovals
nothing
good space
Not sure
Great green spaces available for organised or unstructured sporting play and fitness however the playground is very small and only suitable for a small amount of children and is probably aimed at 1-6 year olds.
fenced off so you can't currently access the park. Is over by the footy pitch.
Like the new netball court. Don't like the playground being on the far side of the oval
I like the site. We previously lived around the road and throughout the last 13 years have spent lots of time at this site with children attending the Netball, Footy and even the Soccer Club when it was there.
Needs to have more of a playground options and would be great to have the playground placed between the netball courts and the fotballovals.
Fantastic oval and courts, playground dates, and would be good if there was a public toilet option open all times
would be nice to see clear pathways from carpark up to the oval. playground to be central to netball & sports club (option 2) and upgraded
My daughter attends netball and I take my 2 year old son to the playground while she is playing / training
The grouping of sports
Like the nature, hate how the car park at the netball doesn't go the whole way around for an exit out the football carpark.
Netball court development has been great.

I like the ease of reaching each sporting destination in the complex and the adequate parking.
Like the car parking.
Lots of oval
Needs a fence for dogs and playground for kids so people stop using the school oval
Needs updated playground in central location. Like the open spaces and trees protecting from carark
Parking is good but could be increased for busy times. Lack of Undercover area - if there was some undercover area this would encourage more outdoor fitness in winter/ autumn.
Play ground far away from netball courts , and club room too small
Like: Lots of trees
Makes the sporting complex more friendly for families
Na
Not a lot i like to be honest its very outdated the whole complex. Playground to babyish, trees near carpark are dangerous and a safety hazard with their roots sticking out. No lighting in carpark area. Previous times their has been sketchy people hanging around in the dark. We also don't need nature play, as there is plenty of nature play around, natural and man made. Musical items will be annoying for people playing sport. Please think of equipment that is different to the rest of park, as a draw card to get people to the area and using it. Otherwise it's a waste of money.
Car park design. It's too unsafe because of blind spots when kids ride bikes.
Too easy access for 4 wheel drive cars to get down the gully
The flooring of the playground is not currently suitable but I like that the playground itself is easy for a toddler to use fairly independently
That playground... make it big for all to enjoy on days of sport and any other time.... and maybe fence off the area.
NA
To far away from netball courts out dated
other playground is too far away from netball facilities.
New parking is great, and new netball club facilities. Current playground is not useable for children at the netball club, as parents can't properly supervise while attending to club responsibilities.
I like that all sports are nearby. I like the renovations and upgrades that have happened. I like that there is lots of car parking. I don't like that football players/spectators park in the netball carparks to avoid paying parking fees. I don't like that the playground is so far away from the netball facilities
Playground too far from netball courts. Not viable from netball courts. Small.. not engaging or big enough for bigger kids. Not enclosed
there is not ample parking for match days/carnivals/events, and the parking on the football oval side is very poorly lit at night
I love the new facilities at the netball club, however the old courts need some work
Facilities need large overhaul especially bathrooms. Externally uneven ground excess foliage
Great open space and facilities for many sporting clubs. Welcome plans to upgrade the playground as it's quite dated and small. A better playground would attract people there at other times to play and also be active on oval etc

Love car park upgrades should be more spaces especially for weekends when sport is played. Casual visitors need separate parking space especially when gates are locked
Some parts need upgrades and thr playground isn't inclusive for everyone that uses the complex.
Likes: The location, close to home and ocean views are beautiful. The fresh air. I feel safe walking and playing with our dog up there.
Dislikes: The tree roots along the pathway leading to the car park pose a significant safety concern, as several individuals have sustained minor injuries such as rolled ankles, and children have tripped and fallen on multiple occasions. Additionally, the lighting along the walkway from the club to the car park is inadequate, particularly in the areas shaded by trees. The existing club facilities are undersized and outdated, and the playground equipment is both aged and insufficient to meet the needs of the community.
Love the new courts, great toilet
Not enough parking or shelter when raining
Playground is too small, lots of children always access the ovals. Existing Playground is great for younger children to play safely. I don't like how there is no gate around the playground to keep children safe from the busy car park.
Low visibility at night between netball courts and oval
More room. Better area
Needs more shelter & wind protection for spectators, needs more seating for spectators, needs a playground for younger kids
The netball carpark is too small for the amount of traffic.
Good parking facilities for footy games
Outdated and very small playground next to football club rooms
I like that the area is large, well kept, ample car parking and a multi activity zone. My children both play sports they always enjoy themselves. I run and complete fitness there multiple times a week.
Love our club, upgrades are great.
Very limited shelter and seating areas, carparking is limited during footy season especially on Saturday games where more games play. Playground needs to be updated location need at least 2 options 1 by netball courts 1 closer to footy club rooms and greater range for all ages groups.
I'm not overly keen on the trees between the netball club and the football club. The playground between them both would be great for both clubs and parents.
Like that there is a new netball complex that has a safer car park. It look inviting to members from other clubs
Too far from netball club.
Lots of options for kids to play and open space.
New facilities for netball
The new netball courts are amazing. The older ones need restoration and there is nothing to connect the football and netball. Also there is nothing for siblings to do when one child is playing club netball. There is no playground in safe proximity.
The play equipment small outdated and far from the netball club
Narrow roads Fast traffic on Lonsdale road make it hard to turn right on Lonsdale rd
You cannot use the "netball" car parking to park for the football. Even though it states it's a community complex, the gates are always locked. There is not enough car parking for the football club, some parking around the oval like other locations would be good especially as it is a winter sport and you can sit in your car

I don't like the playground being so far from the netball court. We can't use it at all as it's too far away from netball. It needs to be accessible to everyone by being in the middle, between the oval and netball. Utilise the trees and make a nature play?!?
The trees which make it look old
The new netballcourts are amazing. Can't wait for the 6 other courts to be resurfaced.
The newly developed netball courts have been absolutely fantastic to play netball on and to train on. The club rooms are inviting and user friendly. Currently kids run over to the football playground which is hard to monitor from the netball courts/club rooms.
Old playground
Not too busy when we go there and safe.
Area needs upkeep, lots of weeds, a bit overgrown. Since netball courts development area is much nicer
Like the open space of the oval and easy access for everyone
Dont like The playground needs updating urgently Always lots of rubbish, needs more grounds keeping maintenance
Newly upgraded courts
The new netball hub is excellent, although not as versatile as the football side.
Too many trees, bird poo on the playground. No sun.
Love the upgraded netball facilities, the current playground is too far away to be of use for my youngest child when her older sister is playing netball.
Love the site, love the new netball hub development. Would be amazing to have a playground for our junior members and siblings.

Summary of results:

Comments are grouped into themes, and have been addressed through the design responses.

Like		Dislike	
Open easy to access site / nice ovals	18	Old playground / not fenced / poor location / low visibility from netball	39
Netball development	16	Car park needs improvement	13
Pathway around new oval	3	Football amenities / sloping oval / old club rooms / poor scoreboard position	10
Good location	2	No public toilets / female changerooms need updating	7
		Lack of lighting in car park	6
		Access to amenities from oval	6
		Lack of seating	5
		Trees / tree roots	3
		Lack of fencing to separate dogs from activities	2
		Maintenance of area	2
		Needs a bike repair station	1
		Dog owners are not respectful	1

Q4. How do you access the Cove Sports Complex?

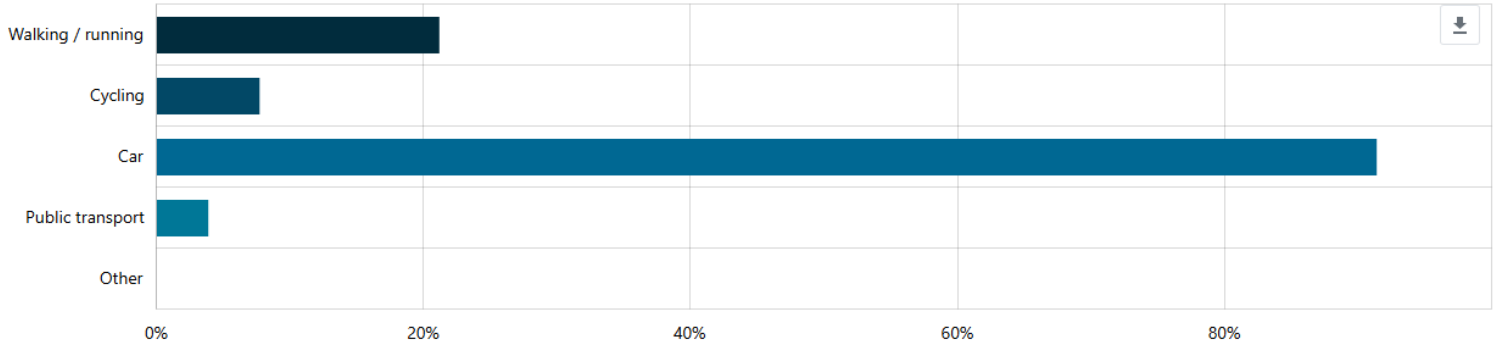

Summary of results:

Most users access the complex via car.

Q5. Please select your preferred location.

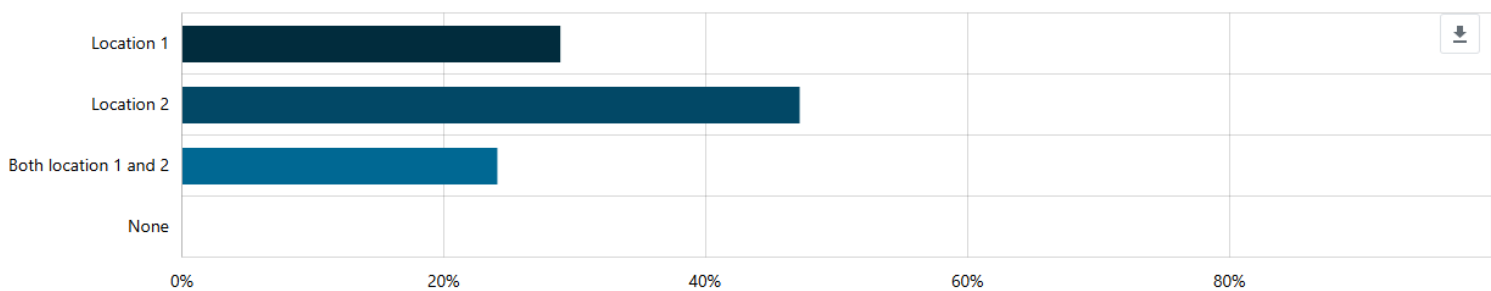
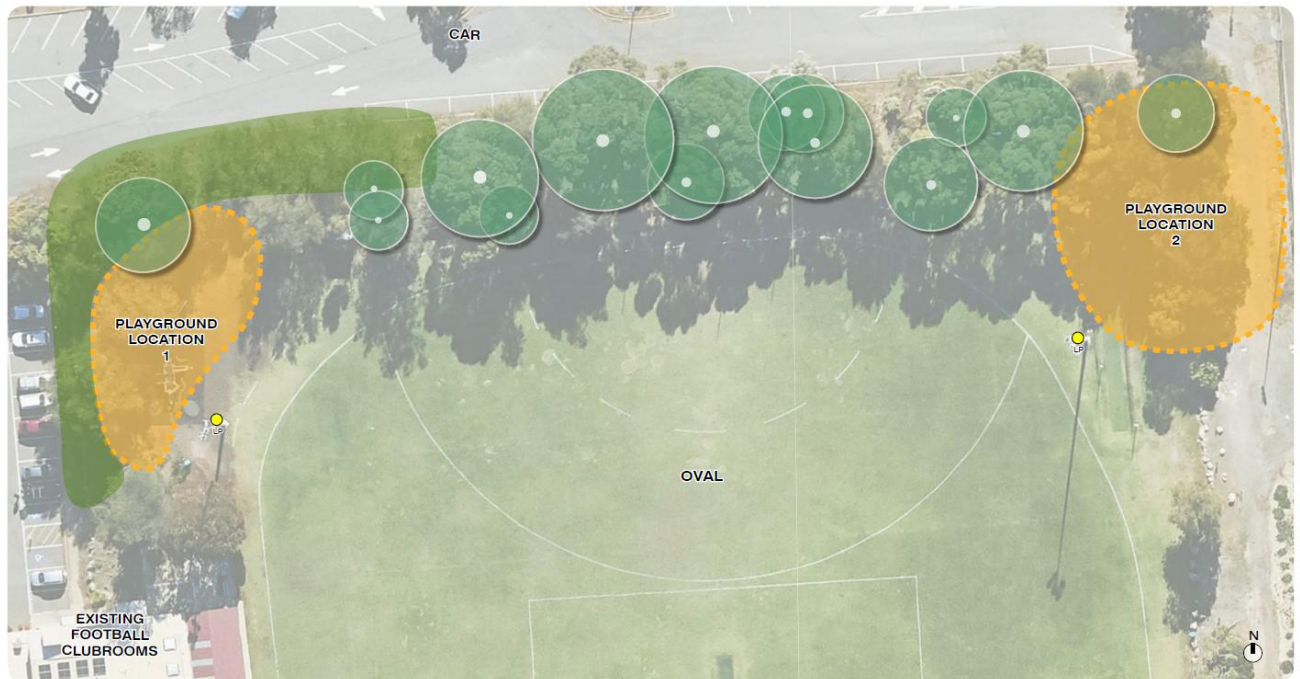

It should be noted that the majority of responders who visit the site to use the netball facilities, chose location 2.

Q6. Please tell us why?

Location 1 - central to the two ovals but incorporate the proposed building redevelopment plans - so it is close by for supervision when clubs are using the two ovals.
Prefer to have it away from football club rooms
Option one would inhibit the proposed new club room location
Close to club rooms where parental can keep an eye on children
It is closest to the club rooms
The play ground needs to be in a good position for parents to make sure their children are safe at all times
I feel having the playground closer to the club room is better for parents when trying to keep an eye on younger kids whilst watching their other kids play footy. Location 2 looks good too as it seems to be bigger, however, location one is more convenient.
Closer to current toilets with the footy/cricket club and facilities especially if sport is happening.
Close to the club rooms makes it easier and safer for parents with multiple children to monitor children on the playground and other children going into and out of club rooms/ change rooms.
Closer to the Clubrooms and central between the 2 ovals.
Where would the cricket nets be located if it's option 2 ? These are in dire need of an upgrade, also. Could they be considered to expand east into the demolished tree area for at least 3 or 4 pitches? For Safety reasons, consideration would be needed on the design of these, given the risk of cricket balls hitting cars or netballers (The trees currently give some cover)
Children accessing the playground will be accompanied by parents watching sport the majority of the time. To allow for adequate supervision and to be close to a baby room/change room, this would be the most convenient location.
2 locations would be good... 1 near the Netball courts and the other close to the football oval where lots of spectators sit so they can watch the game as well as their kids.
Playground needs to be close to football clubhouse where many parents gather and young children can be adequately supervised at all times whilst on the playground. Location 2 is too far away and would only benefit the netball club. My suggestion would be to have two playgrounds to also cater for netball patrons.
If the extension of the football club rooms goes ahead this is a great spot for children to play.
It is closer to the club room and toilets
Closer to amenities
Between the top and bottom oval allows for use when older siblings involved in sports on either field. Safer positioning.
Bigger area and between both the football and netball areas.
Playgrounds available on both sides of the oval servicing all sporting areas (oval 1/2 and netball facilities)
Better access from the car park & clubrooms.
Not so close to the edge of the hill and shouldn't interfere with any club upgrades
Lots of kids
The more the better
1 is next to footy club rooms
2 next to netball so both have merit
in between netball courts and fields

<p>This is where the playground is currently so why change the location? Unless it will be bigger/ have more in location no 2</p>
<p>It is closer to the car park and building</p>
<p>closer to complex</p>
<p>closer to complex</p>
<p>noy sure</p>
<p>In the middle of both main ovals and proximity to Cove Club Rooms.</p>
<p>its between the netball and the oval, in location 2 it can be accessed more easily weather your at the netball or oval facilities. For example, entertaining a sibling while the other is at netball, cricket or footy.</p>
<p>We only use the playground for recreational visits, not when siblings have netball as it's too far away to safely watch they child and still be present for netball children</p>
<p>We utilise the Netball facilities and location 2 is more convenient and visable from both the footy Oval and the netball facility in that location</p>
<p>As it is between the netball and football facilities, as the soccer club has now moved to a new location.</p>
<p>there are so many families using the netball facilities as well as the sports complex so option 2 makes more sense for inclusion and proximity</p>
<p>It's a large site and fair distance between the two, but I would preference Location 2 as its between both facilities .</p>
<p>Central to netball and football. Larger area.</p>
<p>More variety and long lasting for future events or events that are happening on either sides of the oval.</p>
<p>Close to the netball courts, but will the cricket nets be relocated? We currently use both.</p>
<p>It will allow children to access the playground from various sporting venues.</p>
<p>Supports football and netball visitors</p>
<p>Having a small child playground in section 2 as it's central and can be monitored by both netball and footy. And then a larger child one just on footy side.</p>
<p>Closer to netball courts, so younger siblings can enjoy a play time while netball games are played</p>
<p>Looks like the best spot</p>
<p>Splits the football, netball clubs and lower car park perfectly</p>
<p>Number 2 isn't practical. Yes, it's good that it's between netball and football oval, but if football is on no one is suppose to go around close to the boundary, and how are you going to stop kids doing that. Most parents sit club side as their isn't any seating on the other side, so they can't supervise their kids. A fence like other clubs will be good around the oval. Also there is the cricket nets that would have to be moved, which isn't fair on the cricket club thst wants to practice. These clubs pay fees, so they need the space to practice and play. Location 1 is better spot for supervision.</p>
<p>Easier for parents to watch while watching cricket/football. Doesn't remove existing nets.</p>
<p>It is closer to the toilets and club rooms for during footy games when it's dangerous to walk behind goal posts</p>
<p>Can you really have too many playgrounds?.... but if I had to choose one, its #1, central to both ovals etc</p>
<p>It would be close to both netball and football/cricket so children from all sports can us it</p>
<p>near netball court so you can supervise your children and watch and you can watch football from that side as well.</p>
<p>Would be able to be shared better between the 2 sports facilities while watching sporting events</p>
<p>So it is closer to the netball courts, where there are a lot of young children and siblings.</p>
<p>Visible/closer to Netball courts</p>

it is central to all users of the precinct, enabling the netball club and football club to utilise the equipment
Closer to club rooms and general area where people are making it easier for families to keep an eye on younger kids easier
Location one is better for parking I imagine Location 2 is perhaps better for accessibility for netball families for example as sometimes we are reluctant to 'cross the oval' to use the playground when there is footy training on as with young children don't want to go across when balls flying etc.
Current location too far away from netball courts, parents cannot watch netball and younger children at same time. Having playground spaces central to both sport entities is ideal for both sports families. Perhaps consider solar powered lighting for better visibility in early evenings, and toilet facilities
It would be between the football and netball facilities
My children play cricket, football and netball. Having a playground in both locations would serve as a purpose to all sports facilities.
Both netball and footy can access
Beyween noth football and Netball
Closer to club rooms to watch the children and in the middle of the two ovals. So not too far of a distance to get to when accessing both ovals.
Close to netball courts, would be ideal to let my younger children play on while my daughter is training. So the netball families can share the playground & not have young children needing to walk way across the other side of the oval
It would service the most clients if it was between the netball club and the football club. If it was on far side of the oval away from the netball club it wouldn't be suitable for children who are at the netball club.
Close to footy oval and can still watch the game as I'm watching my kids play!
Close to both netball and football facilities
Close to the clubrooms
So there is good spacing for parents with young children during footy games and netball trainings and games.
Because it would be closer for my child to play on while my daughter trains for netball
Better for both netball and footy. Location 1 is only suitable for footy
I like location 2 becauae the kids from thr netball club will be able to use it and be close to their parents.
Can be utilised by both football and netball clubs. Is away from the entry where a large volume of cars enter.
Better access for both football and netball
This location would in safe proximity to the Football and Netball complexes. With the ability to still watch the game and playground. It would benefit both communities it attracts.
Central location for both the football club and netball club.
Caters for both netball and football Close access to carpark
It is a large facility with multiple sporting venues, two playgrounds would be useful so they do not get over crowded or if there is a big kids and little kids playground
Netball kids can't use the playground at all where it is, it's too far for kids to be away from parents. Putting it in the middle (site 2) allows both football and netball families to use it safely.
In between football and netball clubs to allow for maximum patronage
Central to all sports, football, netball and cricket nets.
Not bothered where
More central
It's in between the two locations, there's a very young cohort with netball so closer to the courts is better will get more use there.

Location 1 is nice and central across footy and netball
And location 2 is more spacious
Can be used by both netball and cricket/football kids easily. Closer to all car parks.
It seems ridiculous to me that you are considering putting over near the football club rooms which excludes netball families from using it. The only logical place in my view is option 2 where it can be utilised by as many sports families as possible.
My daughter plays netball so in between both the clubs would be great. We currently cant use it as its too far away to supervise from netball
It is between both the football and netball clubrooms and is much more central for both.
The Cove Tigers Netball club has 26 Junior netball teams, and we use the facility a minimum of three times throughout the week. Our members would love to have the siblings entertained while training and games are being played. Option 2 allows parents and kids to be close to their children playing while also being present while training and games are on. It would not be easily accessible for our members if it was on the other side of the footy oval, they could not supervise their children playing.

Summary of results

Comments are grouped into themes, and have been addressed through the design responses.

Option 1		Option 2		Option 1 and 2	
Close to club / toilets / car park. Between 2 ovals / supervision easier	24	Service all sports	28	Service all sports	11
Stops access around the back of goals during games	2	Close to netball	11	More play options	6
Current location	1	Bigger area	4	Safety	1
		Location 1 will inhibit new club development	2	Close to club rooms	1
		Prefer away from club rooms	1		

Q7. What JUNIOR play experiences would you like to see at this site? (choose 3)

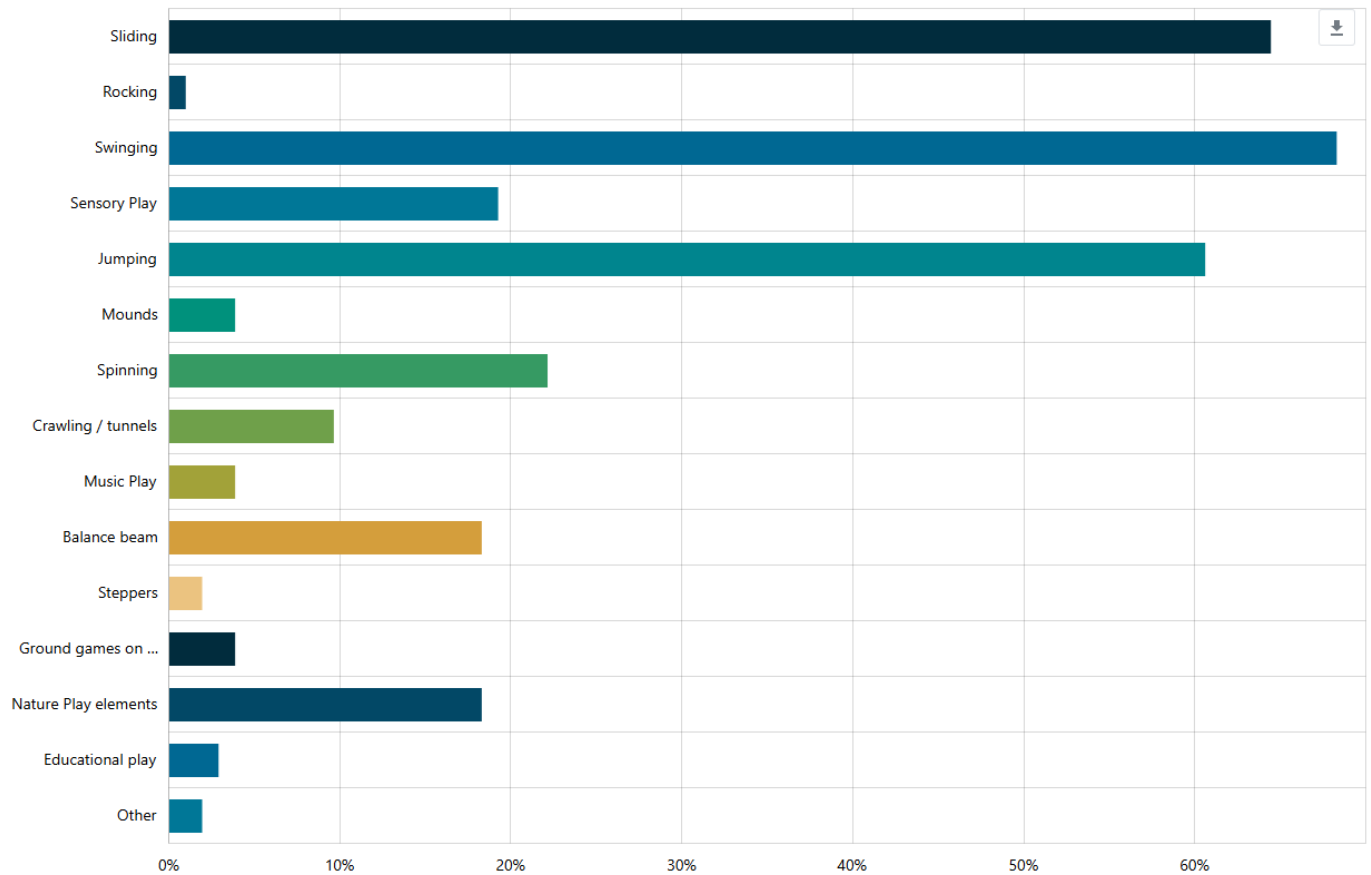

Other – Hamster Wheel, Flying Fox

Summary of results:

Swinging, Sliding and Jumping were the most preferred JUNIOR play experiences.

Q8. What ADVENTURE play experiences would you like to see at this site? (choose 2)

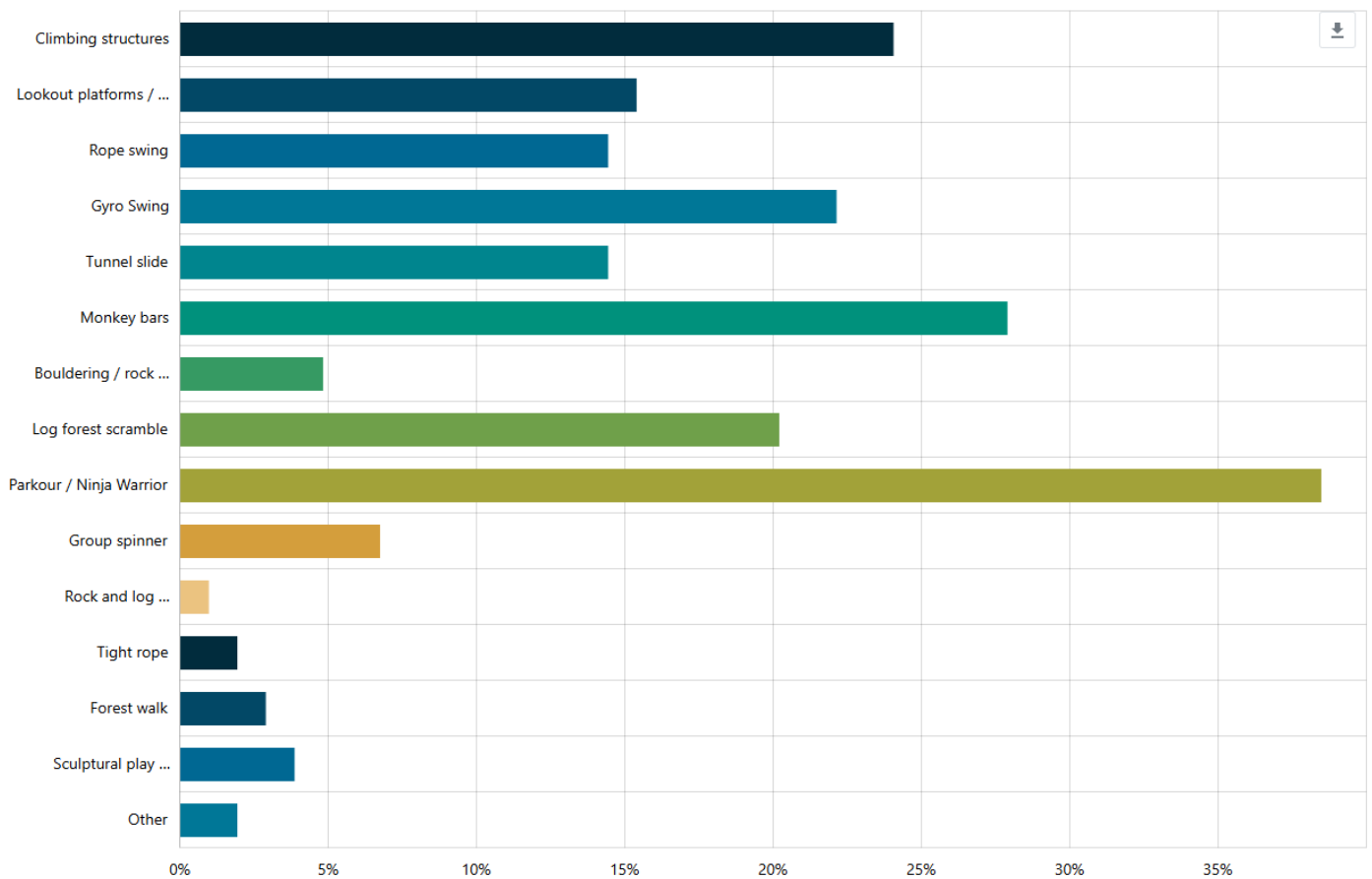

Other – Outdoor Fitness, Hamster Wheel

Summary of results:

Parkour / Ninja Warrior, Monkey Bars and Climbing Structures are the most preferred play experiences, with the Gyro swing also high in preferences.

Q9. What facilities would you like to see at the playground? (choose 2)

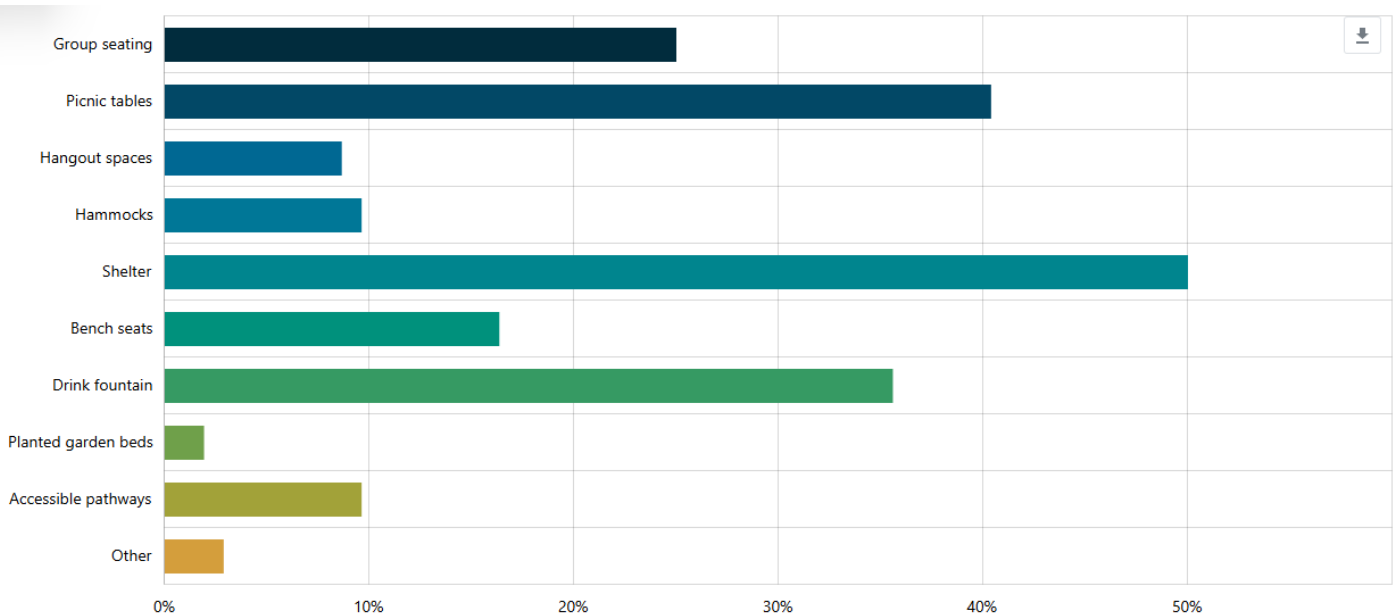

Other – BBQ’s, Dog Bowl drinking fountain, Basketball ring / half court

Summary of results:

Shelter, picnic tables and a drink fountain were the preferred facilities.

Q10. Do you have any other feedback we should consider?

Consider that the associated shelter and seating could incorporate the BBQ shed for use by the Clubs allowing the existing one to be removed from the existing verandah which creates smoke, smells and grease in the congested viewing area. Roller door in front of supplies like fridge etc would be great if it was dual purpose and could be opened on game days with some fold out tables for serving?
Destination for mountain biking would be good - water, basic tool station etc to encourage people to ride trails through field river from Glenthorne to Christies.
Provide security lighting.
Power outlet so it can be used for birthdays etc
Filtered drink station
BBQ areas and dog water bowl similar to shamrock road park
Shade over the top
The date of consultation doesn't align with the day stated
I am not sure if this should be done until it's confirmed that the actual club room upgrades that have been promised for a while now as it may impact the position of both the club room and the playground
Car parking during football season gets very congested and flows out onto the street off road. More parking could be an option
we need more shelter this will help with rainy day sport

I feel like the clubrooms should be a greater priority than a playground.
It's such a great spot with great views, but the clubrooms look old & tired and have ailing fixtures & plant (that Urinal is older than me) and it really would be a great asset to the community if a new facility was built. Not just for the footy & cricket clubs.
Looking forward to the upgrades
This playground should be done in conjunction with the upgrade of the football club
Seating/picnic tables should definitely be included
I could only choose two but the planted garden beds would be nice and my three kids liked the sound of the hammocks.
It would be great if it was more accessible with paths to the oval. Currently only have stairs & when the club is closed you can't access the oval not accessible friendly.
Drink fountain and shelter from sun/rain would be amazing
No
I think it needs to be suitable for young children (2-4) and older children (5-9).
Separate the toodle play space to the older kids area due to the volume of children.
Having a bike path for small child to ride/scoot around while older siblings are playing.
Fence and keep one oval dogs can use
Having the toilet facilities unlocked.
More adventure than junior play elements. Given its close location to the sports communities; more kids that access the area would be at an age where adventure elements are more appropriate
Please put in a fresh water drinking fountain, update toilets and put in seating for people with shade. Exercise equipment could also be good since its a sports complex and a few people use the oval to run laps.
This space is used by local residents daily/weekly and not just football club members. It's important to have a challenging play space for all ages kids.
Just make it good.... you should directly consult with my wife, 100% she'll design you the playground you want!
Make it for all ages.
If its at location 2 then it's close to both the netball courts and football oval.
Perimeter fencing would be appreciated for greater security against young children running off.
Making it safe for the area it gets really busy on game days so still need access for general public to manoeuvre around when there for sport
Fenced surrounds for safety. Lighting solar powered.
Toilet access.
With picnic tables comes bench seating and shelter. 2 choices not enough. Thank you for consideration.
Please try to make it accessible for children with disabilities and not too far from a public toilet. Please also encourage recycling with a cans & bottles bin as well as yellow recycling bins
There is two netball clubs attached to this site which has over 350 netballers plus families. The only sensible option is site 2 as that would mean equal access to both football and netball. If site 1 was chosen the netballers families wouldn't be able to access it.
Toilet facilities accessible when sporting facilities are closed.
Fitness Equipment zone. I see multiple keeping fit on the green area, fitness area would be very valuable.
Fence, please make this helpful to parents with the carpal near by please let, please install a Fence.
Public bathroom as there isn't one there and if no sporting clubs are open there is nothing for use.
There are over 300 players who play for cove netball club. The playground would be useless to the parents of these teams if it was on the other side of the oval.

Much needed , thank you for looking as this
Something for all ages
Toilet use for when clubs are closed
Although between sporting facilities perhaps an exercise element could be included? Sit up bars, cycles, leg press

Comments are grouped into themes, and have been addressed through the design responses.

Public toilets needed	8	Relocate BBQ from veranda	2
Equipment for different ages / Fitness equipment	8	Accessibility to play area	1
Increased shade / shelter	5	Power accessible outside of club rooms	1
Fencing for safety	4	Planted garden beds	1
Drink fountain with dog bowl	4	Increased car parking	1
Increased seating / [picnic facilities	3	Paths to ovals	1
Playground construction to work with club upgrade	3	Biking destination and facilities	1
Increased Lighting	2	Encourage recycling	1

Street

Local residents were positive of the upgrade and made no particular reference to anything that would impact on the local streets.

Suburb

Aberfoyle	1
Christie Downs	4
Hallett Cove	40
Happy Valley	4
Marino	2
Maslin Beach	1
Moana	1
Morphett vale	5
O Halloran Hill	1
Of Noarlunga Sth	1
Port Noarlunga	1
Reynella	3
Seacliff	1
Seaford	1
Seaford Heights	1
Sheidow Park	21
Tonsley	1
Trott Park	10
Woodcroft	5

Social Media

City of Marion
October 18 at 11:00 AM · 🌐

A new chapter of play is coming to Cove Oval! 🌳 ... See more

Cove Sports Playground upgrade

Consultation now open!

Closes 28 October

A great place to play
marion.sa.gov.au

3 👍 2 comments 2 shares

👍 Like 💬 Comment ➦ Share

Lauren Fry
Is there any chance of the club getting the proposed upgrade if you are planning to build a new playground where the plans sho... See more

1w Like Reply Edited

City of Marion
Hi Lauren, the Cove Football club and surrounds are also programmed for potential improvements and early planning has begun. The feedback provided in this consultation will also help to inform how the surrounds to the Cove Football Club could be improved. Read more here:
makingmarion.com.au/cove-sports-playground-upgrade

MAKINGMARION.COM.AU
Cove Sports playground upgrade

1w Like Reply

Only 1 comment was received, and replied to as above.